

# KRUPS

电烤盘 CB672D80

EN

CN



[WWW.KRUPS.COM.CN](http://WWW.KRUPS.COM.CN)

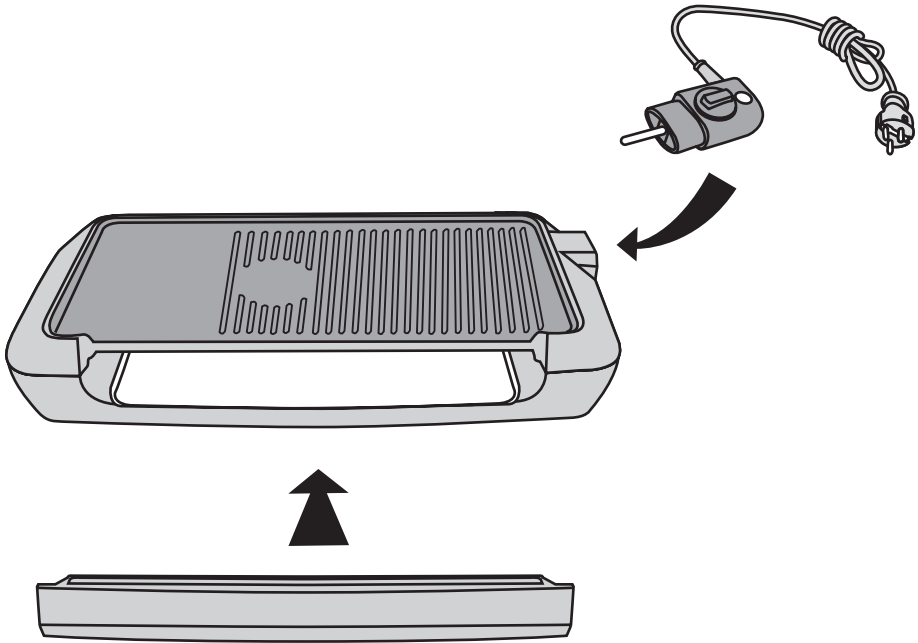



图1



图2

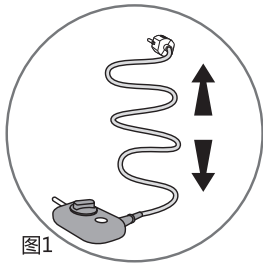

图3

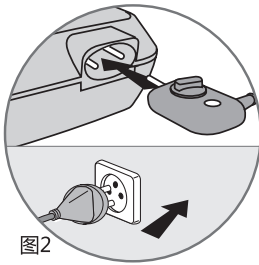

图4

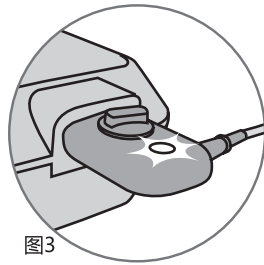

图5

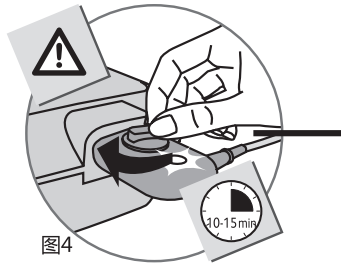

图6



图7

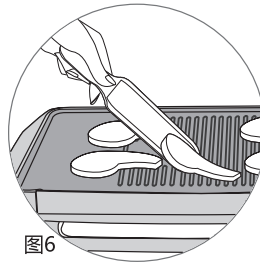

图8

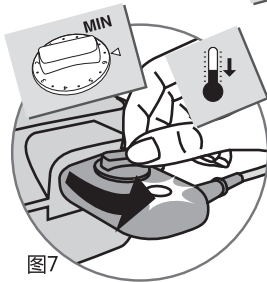

图9

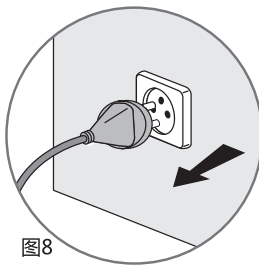

图10

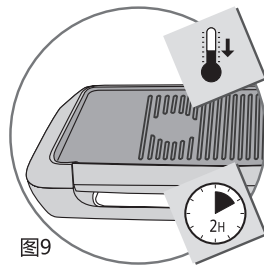

图11



图12

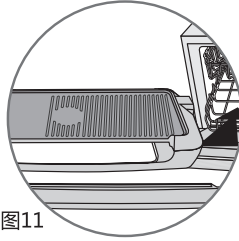

图13





图14

# SAFETY INSTRUCTIONS

## IMPORTANT SAFEGUARDS

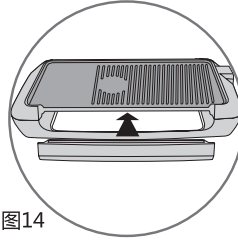
- This appliance must not be used outside.
- This appliance is intended for domestic household use only. It is not intended to be used in the following applications, and the guarantee will not apply for:
  - staff kitchen areas in shops , offices and other working environments;
  - farm houses;
  - by clients in hotels, motels and other residential type environments;
  - bed and breakfast type environments.
- This appliance is not intended for use by persons (including children) with reduced physical, sensory or mental capabilities, or lack of experience and knowledge, unless they have been given supervision or instruction concerning use of the appliance by a person responsible for their safety.

Children should be supervised to ensure they do not play with the appliance and use the appliance as a toy.
-  Accessible surface temperatures can be high when the appliance is operating.

- Remove all packaging materials , stickers and accessories from the inside and the outside of the appliance.
- Fully unwind the power cord.
- Make sure that the electric power supply is compatible with the power rating and voltage indicated on the bottom of the appliance.
- Any connection error may cause irreversible damage and will invalidate your guarantee.
- Given the diverse standards in effect, if the appliance is used in a country other than that in which it is purchased, have it checked by an Approved Service Centre.
- Always plug the appliance into a socket outlet with an earth connection.
- If it is necessary to use an extension lead ensure that it is of suitable construction and power rating , with an earth connection; take all necessary precautions to prevent anyone tripping over an extension cord.
- If the power supply cord is damaged, it must be replaced by the manufacturer or its after sales service in order to avoid any danger.
- The power supply cord should be regularly examined for signs of damage, and if the cord is damaged, the appliance must not be used.

- This appliance is not intended to be operated by means of an external timer or separate remote-control system.
- Never leave the appliance unattended when in use.
- Never immerse the power cord or control box in water or any other liquid.
- This appliance can be used by children aged from 8 years and above and persons with reduced physical, sensory or mental capabilities or lack of experience and knowledge if they have been given supervision or instruction concerning use of the appliance in a safe way and understand the hazards involved.

Cleaning and user maintenance shall not be made by children unless they are older than 8 years and supervised. Keep the appliance and its cord out of reach of children less than 8 years.

- The mobile connector plug must be removed before cleaning the device, and the connector must be dried well before the device is used again.
- You must only use the appropriate mobile plug or mobile connector plug.

### **Thank you for buying this KRUPS appliance.**

Tefal has an ongoing policy of research and development and may modify these products without prior notice.

## **DO**

- Read the instructions carefully, common to different versions depending on the accessories supplied with your appliance, and keep them within reach.
- If the appliance is used in the centre of the table, keep it out of the reach of children.
- Make sure the device is placed in a stable position before using it.
- If an accident occurs, rinse the burn immediately with cold water and call a doctor if necessary.
- Cooking fumes may be dangerous for animals which have a particularly sensitive respiratory system, such as birds. We advise bird owners to keep them away from the cooking area.
- Always use a wooden or plastic spatula to avoid damaging the cooking plate.
- In order to avoid deterioration of the plate, use it only as it was designed to be used (for example, do not place it in an oven or on a stove, whether it be gas or electric).
- Use only the plate provided with the device or a plate bought at an authorized Service Centre.
- Before first use, wash the plate (see paragraph After Use), pour a small amount of oil on it and dry with a soft cloth.



- Before first use, wash the plate (see paragraph After Use), pour a small amount of oil on it and dry with a soft cloth.
- Be careful where you place the electric power cord, whether you use an extension or not. Take all the necessary precautions in order not to hinder people from moving around the table, so that nobody gets tangled or trips over the cord.

## **Do not**

- Never leave the appliance unattended when plugged in or in use.
- To prevent the appliance from overheating , do not place it in a corner or against a wall.
- Never place the appliance directly on a fragile surface (glass table, tablecloth, varnished furniture, etc.) or on a soft surface such as a tea-towel.
- Never place the appliance on or near hot or slippery surfaces; never leave the cord hanging over a heat source (hotplates, gas stove, etc.).
- Do not place cooking utensils on the cooking surfaces of the appliance.
- Never use a knife directly over the plate.
- Do not place the plate on a fragile surface or under water when it is hot.
- Do not move the appliance when in use.

- Do not use aluminium foil or other objects between the plate and the food being cooked.
- Do not cook food in aluminium foil.
- To avoid spoiling your product, do not use flambé recipes in connection with it at any time.
- Do not use metal scourers or scouring powders to avoid damaging the cooking surface.
- Do not remove the grease collector tray during cooking.
- If the grease collector tray gets filled during cooking, let the contents cool before emptying it.

## **Advice / information**

- For your safety , this appliance conforms to all applicable standards and regulations (Low Voltage Directive , Electromagnetic Compatibility , Food Compliant Materials, Environment, ...).
- On first use, there may be a slight odour and a little smoke.
- Do not consume foodstuff that comes into contact with the parts marked with  logo.
- If the electrical box is incorrectly positioned, the safety system will prevent the appliance from working.
- The device will be ready for use once it is preheated.

## Using

- Preheat the device for about 10-15 minutes at maximum temperature - 4 .
- Once the device is preheated, it will be ready for use.
- Fix the thermostat according to the heat level you wish - 5.
- Cook according to taste.
- Thermo-Spot™: when the device is hot, the Thermo-Spot™ icon turns red - 4.

## After use

- Place the thermostat in the min. position - 7.
- Unplug the appliance. Leave it to cool down before cleaning - 8 - 9 - 10.
- Clean the plate and the body of the device with a sponge, hot water and a dishwashing agent - 11 - 12 - 13.

The plate, the plastic base and the collector tray can go in the automatic dishwasher - 11.



### Environment protection first!

① Your appliance contains valuable materials which can be recovered or recycled.

➔ Leave it at a local civic waste collection point.

## 安全指引

- 首次使用前，请仔细阅读使用说明书：任何商业使用、不适当使用或因不符合使用说明而引起的故障，本公司概不负责且不在保修范围内。
- 本产品仅为家用电器。
- 本电器不能使用外置定时器或独立的遥控控制系统。
- 本产品设计和制造的目的是家用电器，并不适用于以下场所，且不在质保范围内：
  - 商店、咖啡馆以及其他工作环境的员工餐厅
  - 农舍
  - 旅馆、汽车旅馆和其他住宅性环境
  - 家庭式旅馆
- 8岁以下儿童、不具备足够身体条件、经验、精神状态或知识的人员不允许使用该产品，除非有人员对他们的安全负责，密切监督并进行指导。
- 请将本产品放置于8岁以下儿童不能触及的地方。
- 切勿让儿童或者不具备足够身体条件、经验、精神状态或知识的人员清洁和维护本电器，除非儿童已满8岁且有人对他们密切监督指导。
- 切勿让儿童玩弄本电器。
- 电器工作时，电器可接触表面温度较高，请勿触摸。
- 首次使用前须取下电器内外所有的包装、贴纸和配件。
- 本电器只能连接到接地的电源插座。请检查当地的电源电压是否与产品所标示的电源电压相符
- 任何错误连接会导致产品保修失效。
- 由于各个国家的电器使用标准不同，如在购买电器所在地以外的国家使用，请将电器送至所使用国家的KRUPS指定服务中心进行检测和维修。
- 出现以下情况，切勿使用电器，为了避免危险，必须由制造商、其维修部或类似部门的专业人员更换。
  - 电源线破损。
  - 电器跌落出现破损或故障。
- 为防止触电，切勿将温控器、电源线或插头浸入水中或其他液体。

- 本烤盘必须与配套的温控器一起使用。
- 切勿将电器放置在发热源或带电的地方。切勿将电器与其他电器堆叠放置。
- 拔掉插头时，切勿拉扯电源线。
- 勿将电源线挂于尖锐的边角或置于发烫、不平稳的表面。

## 正确使用

- 首次使用前，请仔细阅读使用说明书。
- 本品置于桌上使用时，请不要让儿童触碰。
- 使用前确保产品放于平稳的表面。
- 请使用木铲、塑料铲或硅胶铲以防刮花盘面。
- 为避免电器损坏，请按照产品的设计目的使用，例如不要将此电烤盘放置在烤箱或煤气炉上使用。
- 使用过程中，不管将电器放于何处，请注意电源线位置，以免绊倒他人。

## 错误使用

- 切勿在无人看管的情况下使用本电器。
- 为了防止过度加热，请确保电器的四周空气流通顺畅，不要放置在角落或靠墙位置。
- 切勿将此电器及电源线放置于接近热源的地方、任何湿滑的表面及锋利的边缘。
- 请勿在本电器上放置其他厨房工具。
- 请勿直接在烤盘上使用刀具。
- 产品使用过程中请勿移动。
- 请勿使用锡箔纸或类似物品包裹食物。
- 烹饪过程中请勿取出接油盒。

## 温馨提示

- 为了您的安全，本产品符合适用的标准和法规（3C认证，食品接触，环境等要求）。
- 前几次使用电器时，有轻微的冒烟或者新机器味，属于正常现象。以上情况会随着使用次数增加而消失。
- 不要食用与标有不可食用标识的部件接触的食物。
- 如果温控器没有正确连接,本产品将不会正常工作。
- 本产品使用前请预热。

## 使用方法

- 温控器旋钮在“0”档时通电，绿色电源指示灯亮，进入待机状态（红色加热指示灯不亮）。
- 温控器旋钮旋至其他档位（1-6档），红色加热指示灯亮，电器开始加热，到达每个档位的设定温度后，红色加热指示灯熄灭。
- 通电后以最高温预热10-15分钟-图4。
- 预热结束后,机器可以开始烹饪食物。
- 根据食物烹饪需求调节温控器上温度调节钮-图5。
- 根据个人口味添加调味料。

注意：绿色灯为电源指示灯，红色灯为加热指示灯。

## 用后清洁

- 温控器上调节旋钮调至最低档位-图7。
- 先拔下电源插头，再拔下温控器，待机器冷却后再进行清洗-图8-图9-图10。
- 请使用海绵、热水及清洁剂清洗主机-图11-图12-图13。  
烤盘、底座及接油盒均可使用洗碗机进行清洗-图11。
- 清洗后用干软布擦干，通风放置。
- 切勿使用百洁布或钢丝球清洁维护本电器，以免刮伤烤盘。
- 请勿将温控器放于水中或洗碗机中清洗-图13。

## 执行标准

本系列产品执行国家标准：

GB4706.1-2005

GB4706.14-2008

QB/T 4407-2012

## 回收利用

请妥善保管说明书以便日后查阅。



① 让我们一起

🔄 保护环境！

您的电器包含很多可循环再用或可回收的材料。  
请将电器送往城市垃圾收站。

## 环保清单

部件名称	有害物质					
	铅 (Pb)	汞 (Hg)	镉 (Cd)	六价铬 (Cr(VI))	多溴联苯 (PBB)	多溴二苯 醚(PBDE)
感温棒组件	O	O	O	O	O	O
储油盒	O	O	O	O	O	O
支架连接座	O	O	O	O	O	O
左把手支架、右 把手支架	O	O	O	O	O	O
反射板	O	O	O	O	O	O
隔离板	O	O	O	O	O	O
电源线	O	O	O	O	O	O
插头	O	O	X	O	O	O
温控器	O	O	O	O	O	O
左把手、右把手	O	O	O	O	O	O
发热管	O	O	O	O	O	O
烤盘	O	O	O	O	O	O
标签类	O	O	O	O	O	O
内部连线	O	O	O	O	O	O
五金件(螺钉类)	O	O	O	O	O	O

本本表格依据SJ/T 11364 的规定编制。

O：表示该有害物质在该部件所有均质材料中的含量均在GB/T 26572 规定的限量要求以下。

X：表示该有害物质至少在该部件所有均质材料中的含量超出GB/T 26572 规定的限量。

说明：1、⑩该符号中的数字表示上述产品在按说明书要求的使用条件下的环保使用期限。

2、有害物质中铅(Pb)、汞(Hg)、镉(Cd)、六价铬(Cr(VI))均代表金属及其化合物。



## 食品接触材料信息表

请根据说明书要求正常使用本产品。

本产品食品接触用材料及部件符合GB 4806.1-2016和相应食品安全国家标准要求，具体信息如下：

食品接触用材料		用途	执行标准	备注
金属	铝合金ADC-3基材	烤盘	GB 4806.9-2016	牌号符合日本标准JIS H5302:2006
涂层	聚四氟乙烯涂层（铝合金ADC-3基材）	烤盘	GB 4806.10-2016	如涂层脱落，建议更换烤盘，烤盘使用温度不得高于250度。

注：1、产品不宜作为容器长期存储食品；

2、最高温度不得高于250℃，单次使用时间不得超过2小时。

## 售后服务

本公司电烤盘自购买日起提供两年保修服务，保修期的起始日期以所购产品的发票日期为准。在正常使用情况下，非人为导致的破裂或损坏，购买者可以带上保修卡、发票和损坏产品到特约维修点办理维修。

下列情况之一者，不属于免费维修范围：

- 未按说明书要求操作而造成的故障；
- 自行装拆、修理而造成的故障；
- 意外、误用、乱用、故意损坏而造成的故障；
- 不可抗拒的自然灾害造成的损失（如地震、水灾、火灾等）。

**对于超过保修期或不属于免费维修的产品，本公司顾客服务部也会热情为您服务。**

- 质保期外提供终身维修服务；
- 制造单位有改型的权利，恕不另行通知。

### 用户反馈

承蒙惠顾KRUPS产品，谨此致以谢意！如您遇到服务不周的情况，请拨打全国服务热线400-826-9800，我们将给与您满意的答复。

### 顾客服务部联系方式：

地址：浙江省杭州市滨江区江晖路1772号9F

全国服务热线：400-826-9800



WWW.KRUPS.COM.CN

2100107025